

Vol 23 no 4

THE ESSENTIAL GUIDE TO WESTERN AUSTRALIAN ART GALLERIES

Gallery CIRCUIT

Oct_Dec_2010 FREE



Shaun Atkinson *Pura Segara* 2010 oil and gold leaf on canvas, 160 x 140 cm @ Greenhill Galleries

Gallery CIRCUIT

Members of the Association of Western Australian Art Galleries

www.awaag.org.au

Page

Art Gallery of Western Australia	04 - 05
Breadbox Gallery	22
Central TAFE Art Gallery	06 - 07
Emerge Art Space	12
Fremantle Arts Centre	14 - 15
Galerie Düsseldorf*	08 - 09
Gallery East*	10 - 11
Gomboc Gallery Sculpture Park	13
Greenhill Galleries*	16 - 17
Heathcote Museum and Gallery	20 - 21
Holmes à Court Gallery	18 - 19
Indigenart - Mossensons Galleries	23
John Curtin Gallery	26 - 27
Kingfisher Gallery	28 - 29
Lawrence Wilson Art Gallery	30 - 31
Lister Gallery	32
Moore Building Contemporary Art Gallery	34 - 35
Perth Galleries*	36 - 37
PICA	38 - 39
Prison Gallery	33
Seva Frangos Art*	40 - 41
spectrum project space	44
Stafford Studios	42 - 43

*Authorised Valuers for the Federal Government's Cultural Gifts Program

Gallery Circuit Map

24 - 25

Art Gallery of Western Australia

Perth Cultural Centre Perth WA 6000

Information Line (08) 9492 6622

www.artgallery.wa.gov.au

Entry by donation (An entry charge may apply for special exhibitions.)

Gallery Exhibitions and Gallery Shop hours 10am - 5pm Closed Tuesday

Gallery Cafe daily hours 8am - 5pm

9 Oct - 31 Jan 2011

Peggy Guggenheim: A Collection in Venice

As the first exhibition in a new series titled Great Collections of the World, the Art Gallery of Western Australia brings a world-class exhibition from the Peggy Guggenheim Collection in Venice exclusively to Perth. The works in the exhibition display Peggy Guggenheim's strong affinity for two key movements of 20th Century modern art: Surrealism and Abstraction.

For further information on the great line up of events, lectures, films or tours, visit greatcollections.com.au

Tickets are available at the Art Gallery Shop and through BOCS Ticketing. Call BOCS on 9484 1133 or visit bocsticketing.com.au

This exhibition has been organised by the Solomon R. Guggenheim Foundation, New York and the Art Gallery of Western Australia.



Vasily Kandinsky

Upward 1929

oil on cardboard

Peggy Guggenheim Collection, Venice

© Vasily Kandinsky/ADAGP.

Licensed by Viscopy, 2010

Western Australian Indigenous Art Awards 2010

Until 3 January 2011

The Western Australian Indigenous Art Awards is a national art award founded in 2008 to celebrate the diversity and richness of Indigenous art from across the country. The awards acknowledge the significant contribution Aboriginal and Torres Strait Islander artists make to Australian art and culture.

Wakartu Cory Surprise

Wayampararti 2009

synthetic polymer paint on canvas

120 x 119.8 cm

Artwork courtesy of a private collection

Image © Wakartu Cory Surprise, courtesy
of Mangkaja Arts, Fitzroy Crossing



Alberto Giacometti

Woman with her throat cut 1932

bronze, cast 1940

Peggy Guggenheim Collection, Venice

© Alberto Giacometti/ADAGP. Licensed by Viscopy, 2010



GALLERY CENTRAL

12 Aberdeen Street Perth WA 6000

Tel (08) 9427 1318

www.gallerycentral.com.au Email: gallery@central.wa.edu.au

Gallery hours Mon - Fri 10am - 4.45pm

Sat VARIES, Closed Public Holidays

Gallery Central was formerly Central TAFE Art Gallery. Central TAFE has changed its name to Central Institute of Technology.

16 - 30 Oct

To the Centre - Where the Heart is ...

Textile artist Margaret Ruane and painter Lia Overman reflect on an emotional response to the environment.

On view Tues - Friday 11 - 6 and Sat 2 - 4.45

29 Oct - 6 Nov

Foto Central

Works from our graduates, lecturers and students that showed in FotoFreo.

10 - 20 Nov

Auspex Australis

Step inside a 5 metre wide portable dome for a 20 minute music, sound and video installation developed by an international team of artists, musicians and environmental scientists including WA artist David Carson. The project looks at the global significance of the Christmas Island seabird project in the Indian Ocean, where the study of bird activity can be used as a barometer for global warming.

Weekdays 10 - 4 and Sat 2 - 4

19 - 27 Nov

Blanket Queen

Katherine Morrison is a New Zealand textile artist whose work deals with issues of care, protection, memory (and humour). She is inspired by the symbolic importance of blankets and their place in history. This exhibition includes coats made from hand embroidered recycled blankets.

A season of graduate exhibitions for Creative Industries including -

Graphic Design On view: 25 - 27 Nov

Photography On view: 2 - 4 Dec

Visual Art, Jewellery and Object Design

Opening Wed 8 Dec On show: 9 - 15 Dec

Auspex Australis





Katherine Morrison *Blanket Queen*

Galerie Düsseldorf

9 Glyde Street Mosman Park WA 6012

Tel/Fax (08) 9384 0890 www.galeriedusseldorf.com.au

Email: gd@galeriedusseldorf.com.au

Gallery hours Wed - Fri 11 am - 5 pm, Sun 2 pm - 5 pm
and by Appointment (Closed Public Holidays)

10 - 31 Oct (preview from 6 October)

**MARZENA TOPKA : light weeks away
drawings, video, glass**

In light weeks away measurements are translated into an altered set of conditions by the means of material substitutions. They cross the line, they loose their boundaries and they relinquish their claim on reality. Equally they are evacuated from their own rigidity and taken for a 'recuperative holiday' that will perhaps allow them to catch a different drift. Translation loosens the grip of certitude, exposing the inability to find the right fit for each situation.

Processes play an important part in my work. It matters whether or not the materials are dissolved, fixed, fired, wound up, cut, distorted, sagging or nearing a collapse.

I am interested in the loss of certitude. The devices that I am using in the process of making perform useful functions in ordinary life. However here they are being tested and pushed to their limits. Subverting their functions initiates possibilities for things to redefine themselves.

Lines which delineate boundaries and organise forms become fugitive. They follow a path of deterritorialisation, whether they may take the form of drawings with ink on paper or with thread in thin air. Liberated from the lack of finality, they form an optimistic relationship to the future. There are holes in the grid and the future is open. light weeks away is about the possible.

Marzena Topka *Constellations* 6 2010 (Detail)
Digital Print Unique Series 29.7 x 21 cm

below:

Marzena Topka *colour therapy* 2010 dvd still 2min39secs

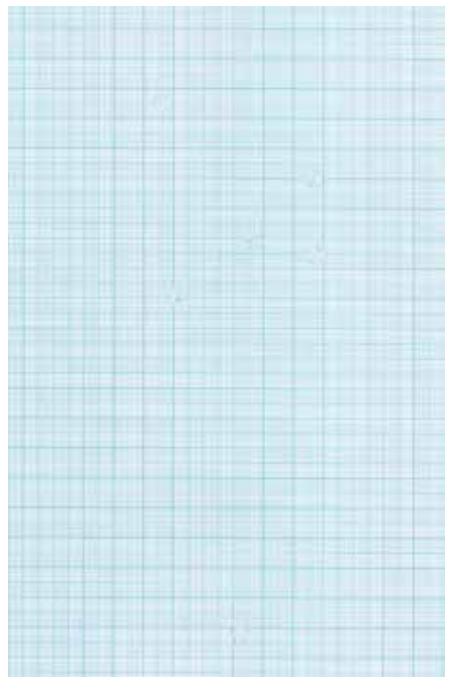

14 Nov - 12 Dec

TOM MÜLLER : LUSTER OF ETERNITY

The central question of how we relate to the planet as a species and how we interact together represents the core of Müller's practice, which explores ecological systems, magnetic forces and underlying networks of connectedness. His interest in the complexity and connectivity of natural structures and processes is a catalyst for a range of works in different media, each new project exploring the patterns that influence and direct human interactions. Some of these modes of engagement derive from the natural world, others, like the control of our movement across the globe, we create ourselves, but as Müller shows us, all can be charted graphically.



Tom Müller *Aether Atolls* 2010 ink on archival paper 60 x 50 cm



This project has been assisted by the Australian Government through the Australia Council, its arts funding and advisory body.



Tom Müller *The Luster of Stillness* 2010
brass, copper, acrylic, synthetic polymer
20 x 100 x 12 cm

Gallery East

94 Stirling Highway North Fremantle WA 6159
Tel (08) 9336 6231 Fax (08) 9336 2678
www.galleryeast.com.au Email: admin@galleryeast.com.au

Gallery hours Tue - Sat 11 am - 5 pm
Sun 2 pm - 5 pm (Closed Public Holidays)

24 Sept - 17 Oct

Viewpoints: new works by Tony Windberg

In Tony Windberg's latest work, all is not what it seems. These multi-dimensional, wall-mounted constructs change with shifting viewpoints: flat surfaces appear curved, curved become flat. Through the intricately engraved marks on imitation wood vinyl are seen clearings and the monoculture of blue gum plantations near the artist's studio in Northcliffe in south west Western Australia. These constructed scenes invite the viewer to question the nature of illusion and the illusion of Nature.



Tony Windberg *Vanishing points* Engraved vinyl, Marri resin, painted mdf. 90 (h) x 1345 (w) x 52 (d)

22 Oct - 14 Nov

Martin Heine, paintings

Martin Heine works from the back of the 'canvas', pushing colour through holes in the weave, to produce brilliant patterns of tiny dots, pixels in paint, a plastic equivalent of a life in which all that was once solid slips away. These sophisticated surfaces echo a sinister fragility while remaining charming and accessible. In his latest work he seeks to engage the fragility of memory and desire through landscape, the exuberance of the disco and remote urban encounters, erotic and social.



Martin Heine: *Bridge - inversion* 174 acrylic and oil on synthetic polymer, 65 x 85 cm

19 Nov - 19 Dec

The Great Little Christmas Show

Paintings, prints, sculptures, ceramics, jewellery and icons in miniature for the ideal unique seasonal present, created by Gallery East's artists and sourced from around the world and from down the centuries..



Toyohara Kunichika the actor Ichikawa Danjuro IX in the role of Kumonaju Shishin woodblock print 1898

The Gallery re-opens on Sunday 16 January 2011 with the exhibition **INKED!**
Tattoos in Japanese prints & in the work of Paul Binnie, together with the ceramics of Amanda Schelsher

emerge ART SPACE

676A Beaufort Street, Mt Lawley 6050

Tel: (08) 9271 6459 A/H 0417 184 638

www.emerge-art.com.au admin@emerge-art.com.au

Gallery hours Wed-Sat 11 am - 4pm and by appointment
Closed school and public holidays

12 - 29 Oct

Jimmy McKenzie Texas

Jimmy McKenzie was born on Texas Downs station near the Bungle Bungle Massif (Purnululu) in the East Kimberley. His early adult years in this country were spent working the stock camps with his mother acclaimed ochre artist Queenie McKenzie, along with many of the Warman artists who acquired renowned international acclaim most notably Rover Thomas, George Mung Mung, Hector Jandany and Jack Brittain.

Jimmy began painting in 2009 with Red Rock Art in Kununurra and has quickly gained recognition for his work which is typical of the Warman genre. He works only with natural ochres collected and prepared by hand, and demonstrates a natural talent for the use of texture and space. *Texas* is Jimmy's first solo exhibition.

right: Jimmy McKenzie *Baloowa (Violet Valley)* 2010, ochre on canvas, 90 x 120cm (courtesy Red Rock Art and emerge ART SPACE)

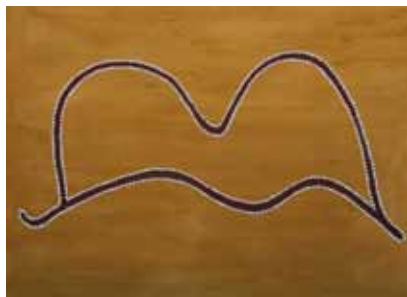

10 - 26 Nov

Reconfigured - Figurative Group Show

Reconfigured is a group figurative exhibition that will showcase both local and interstate artists. Featuring new works by these twelve talented artists Kirstine Sadler, Gigi Hesterman, Sharon Dawes, Kathryn Haug, Dianne Gall, Claire Steele, Karen Seaman, Richard Maurovic, Jonah and Chris Cacioppe, Francesco Villicich and Ben Sherar.

30 Nov - 12 Dec

The Affordable/Collectable Lockhart River Show 2010 - Lockhart River Artists' Group Show

A group exhibition from the highly acclaimed Lockhart River Art Community, far north eastern Cape QLD of small to medium works that as the title suggests are both affordable and collectable. The work will include both established and up and coming artists such as Irene Namok, Cheryl Acoom and Patrick Butcher. A not-to-be-missed exhibition!

Middle right: Kirstine Sadler *The Morning* 2010, oil on canvas, 100 x 56cm (Image courtesy the artist and emerge ART SPACE)

Bottom right: Cheryl Acoom *Fishing with Joanne* 2010
acrylic on canvas, 86 x 94cm. (Image courtesy the Lockhart River Art Community and emerge ART SPACE)



Gomboc Gallery Sculpture Park

James Road Middle Swan WA 6056

Tel (08) 9274 3996 Fax (08) 9274 2665

www.gomboc-gallery.com.au Email: rm@gomboc-gallery.com.au

Gallery hours Wed - Sun 10 am - 5 pm

Oct to Dec

Paintings and sculpture by Gallery artists.

We wish everyone the Compliments of the Season and advise that Gomboc Gallery will open by appointment only, from Sunday 18 December until 11 February 2011.

The stuff that through the green stem drives the flowers
Jon Denaro



The Dance of Life (Thank you Munch) Andrew Sibley



Fremantle Arts Centre

1 Finnerty Street Fremantle WA 6160
Tel (08) 9432 9555 Fax (08) 9430 6613
fac.org.au Email: fac@fremantle.wa.gov.au

Open daily 10am - 5pm
Free admission to all exhibitions

25 Sep - 21 Nov

Fremantle Arts Centre Print Award 2010 supported by Little Creatures Brewing

Fremantle Arts Centre presents its annual vibrant snapshot of contemporary prints and artists' books. More than 45 emerging and leading Australian artists have been selected, giving audiences an opportunity to enjoy the diversity of this exciting art form. In its 35th year, the Fremantle Arts Centre Print Award supported by Little Creatures Brewing continues to invigorate and challenge the notion of print.

The Award offers four prizes including the \$12,000 major acquisitive prize and the and \$5,000 non-acquisitive prize.

25 Sep - 21 Nov

James Dodd: Boab Inscriptions

South Australian artist James Dodd takes inspiration from our state's unique landscape for his exhibition of painting and installation works. Dodd's residency at FAC has taken him on a unique journey through the Kimberly region. He has collected the handcarved text and markings found on our native Boab trees, incorporating them into his own eclectic style in this exhibition of new works. A respected street artist, his practice traverses a wealth of influences to present a rich and dynamic interpretation of street art and culture in a gallery environment.

27 Nov - 21 Jan

HOME OPEN

Fremantle Artists and their Collections

Fremantle Arts Centre presents a special exhibition, which tells the story of Fremantle's artists and their own personal collections. Accept an invitation into their homes - a sprawling meditation on the multiplicity of our creative minds, Home Open reflects the diversity and energy of Fremantle's artists and their surroundings.

Artists create environments that reflect who they are and what they make. With an eye for design and attention to detail, they collect furniture, art, objects and artifacts that continue to inspire and motivate.

Just as these collections tell the story of the artist, and provide clues as to their method and their lifestyle, each object has a tale of its own. How a painting, an item of furniture, or a collection of rocks came into someone's life becomes as important as the object itself. Where did it come from, and why is it important?

A range of painters, sculptors, street artists, gallerists, printmakers, textile artists, photographers and more bring together their private memorabilia in a very personal exhibition at FAC. A generous exhibition, detailed installations reflect the distinctions between generations and artistic practices. From immaculate displays of perfectly restored furniture, to chaotic hangs with artwork piling the walls, floors and ceilings, these rich and textured displays invite audiences into the homes of the artists who have made Fremantle what it is today.



Greenhill Galleries

6 Guger Street Claremont WA 6010 Tel (08) 9383 4433
www.greenhillgalleries.com Email: info@greenhillgalleries.com

Gallery hours Tues - Fri 10 - 5 pm
 Sat 10 - 4 pm

Greenhill Galleries showcases a collection of local, interstate, and international artworks, representing many of Australia's finest contemporary artists, including the esteemed Australian artist, ROBERT JUNIPER.



Marcella Kaspar Satan's Bride oil on linen 122 x 167 cm

15 - 30 Oct : Marcella Kaspar: Floral Whispers

Marcella Kaspar focuses on the beauty and repetition in nature, freezing the moments and imprisoning, concentrating on refining and perceiving light and dark through the 17th century techniques of opaque layering with transparent glazing. "There is an obsession in my work with the ephemeral nature of flowers and how they reflect the transient nature of life. There is also a constant fascination with the transparency of water, and the play of light, colour, temperature and atmosphere that makes up the subject". Kaspar attended the prestigious Julian Ashton Art School in Sydney (as well as the Charlie Sheard Studio School), travelled the world on a study tour over a period of eight years in the 1980's, and studied drawing in Japan in 2007.



Nigel Hewitt *Fissure I and Fissure II* wax, ash, muslin and oil on canvas 2 (40 x 40) cm

31 Oct - 13 Nov : Nigel Hewitt: The Inland Sea

With a successful artistic career spanning more than 30 years, revered Perth painter, Nigel Hewitt, returns to Greenhill Galleries with *The Inland Sea*; a journey of exploration into Australia's literal and metaphorical history. This body of work considers the impact of the misguided ventures and explorations of the early colonialists. Through the layers of wax washes and intricately painted details, these images are ambiguous and create an interesting sense of space that goes beyond the typical use of two-dimensional perspective. With acute attention to every detail in his drawing, the execution of Hewitt's artwork is flawless and the resulting technique, like none other. In 2009, Nigel won the prestigious Black Swan Prize for Portraiture with his painting of Richard Woldendorp. This year he entered a impressive depiction of Robert Juniper.



Shaun Atkinson *Trinity* Oil on canvas 2 (120 x 160), 1 (140 x 160) cm

19 Nov- 4 Dec : Shaun Atkinson: Sea Temples

Sea Temples, is inspired by a series of Balinese Temples that pay homage to the sea. These sea temples have a powerful other worldliness about them, commanding a powerful presence and aura. "I was inspired by this atmosphere, and by juxtaposing the silhouetted shapes of the Sea Temples against the three key elements the Sky, Sea and Land..." Shaun Atkinson is a fortunate artist, living part of the year in Margaret River and part of the year in Bali. As he describes it, it is a "...wonderful yet challenging experience." The resulting works, using materials such as gold on silver leaf, are a visual diary of the time spent in these diverse locations; a journey rich in culture and imagery.

Holmes à Court Gallery

11 Brown Street East Perth WA 6004

Tel (08) 9218 4540 Fax (08) 9218 4545

www.holmesacourtgallery.com.au Email: hacgallery@heytesbury.com.au

Gallery hours Wed - Sun 12 - 5 pm
or by appointment

Until 17 Oct

Lavage - Géricault, Delacroix and Courbet Revisited

Thomas Hoareau

Thomas Hoareau is producing five large-scale works for this exhibition, reworkings of five classic historical paintings, including a reworking of Théodore Géricault's *The Raft of the Medusa*. The exhibition will be an interesting and engaging one with Hoareau's 'homages' changing the settings to contemporary Midland, layering the works with underlying social commentary as usual with familiar faces present.

Thomas Hoareau is a prizewinning artist who has exhibited regularly in Perth since 1981 and is represented in the National Gallery, the State Gallery, and various public and private collections. Hoareau continues to practise his art at his Viveash studio.

School of Perth - Artists' forum Sunday 3 Oct 4-6pm

The presenting artists - Tania Ferrier, Richard Gunning, Thomas Hoareau, Kevin Robertson and Megan Salmon - will reflect on the formative period of their emerging practice and elaborate on the salient issues that determined the direction of their art-making in Perth.

\$10.00 cost. Free to students. Registration is essential on 9218 4540.



Thomas Hoareau
Viveash on the Verge of Suburban Development
2010
acrylic on canvas 183 x 123cm



Thomas Hoareau *Lavage - The Raft of the Medusa in Midland* 2010
acrylic on canvas 183 x 214cm

From 13 Aug 2010

Ten

Highlights of Acquisitions to the Collection 2000-2010. Holmes à Court Gallery at Vasse Felix, Margaret River

As you may know Holmes à Court Gallery at East Perth is closing at the end of October.

We will be continuing our program of exhibitions and events at Vasse Felix, Margaret River.

Our contact details will remain the same until further advice. See www.holmesacourtgallery.com.au for updates. You may register your email address there via the contact form.

Ten exhibition at the Vasse Felix gallery



Heathcote Museum and Gallery

Heathcote Cultural Centre Duncraig Road, Applecross 6153
Tel (08) 9364 5666 (wheelchair accessible)
www.melvillecity.com.au claire.bushby@melville.wa.gov.au

Gallery hours Tue - Fri 10 am - 3 pm
Sat and Sun 11 am - 3 pm

9 Oct - 14 Nov 2010

Katie Martin, Mandy Harwood & Roderick Sprigg
the now recent past

Three WA artists take an open-minded approach to traditional views of rural Australia. Exploring the cultural tapestry woven from the fibres of an Agri-lifestyle. With a subjective inquiry into farm ideology, contemporary manhood and fantasy of the land, these artists respond intuitively with sensory awareness and diversity of materials



Katie Martin *Multiply and Divide*

20 Nov - 19 Dec

Paul Caporn and Kate Gregory

Tilt 2010: Absence of occupation is not rest

For Tilt 2010 Paul Caporn will be dealing with the relationship between history museums and art galleries. This will be driven through a collaborative process between Caporn and Dr Kate Gregory, historian from the National Trust. The collaboration between an artist and historian will enable archival voices to be unearthed for inspiration. By mining the archive and drawing out elements of the history of the site through the installation, the project will be grounded in a relationship between the present and the past. The work will interpret aspects of the history of the site bringing a new reading of the past to Heathcote Gallery and Museum. Tilt is an initiative by the City of Melville where one artist each year is invited to showcase their talents by exploring an aspect of Heathcote's multi-layered history, using their chosen art medium or a new exploratory medium.

Paul Caporn Installation Layout

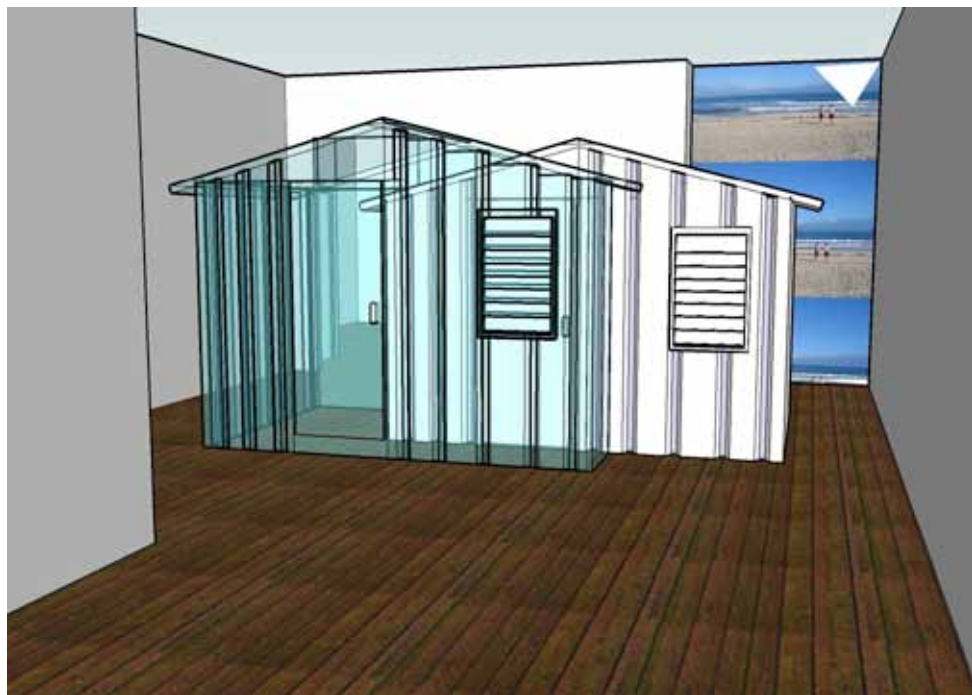

Breadbox Gallery

The Bakery ARTRAGE Complex 233 James Street Northbridge
 Tel (08) 9227 6288 Email: breadbox@artrage.com.au
 E: HELLO@ARTRAGE.COM.AU / www.artrage.com.au
 please check website for current information

NEW ARTRAGE COMING...

ARTRAGE is closed to implement a very exciting development project. With support from Department of Culture and the Arts' Arts Capital Fund and Western Power we're taking The Bakery Artrage Complex to the next level.

When it re-opens in 2010, the complex will inject a new style of innovative cultural infrastructure into the Perth system. We can't wait to share it with you.

Whilst the doors are closed the pots still bubbling, and we'll be announcing some great new support and development programs, venue programs, special projects and partnerships and information about the next ARTRAGE Festival over the year. Make sure you're on the ARTRAGE email list to stay informed.



**ARTRAGE CLOSED... WHILST WE REFURBISH OUR VENUE.
 STAGE 1 REDEVELOPMENT PROJECT STARTS JUNE.**

**JOIN THE ARTRAGE EMAIL LIST TO RECEIVE A SPECIAL SUBSCRIBER INVITE TO
 THE RELAUNCH EVENT & STAY IN THE LOOP ABOUT OTHER ARTRAGE HAPPENINGS
 OCCURRING DURING OUR BUILD TIME.**

Indigenart - Mossenson Galleries

115 Hay Street Subiaco WA 6008

Tel (08) 9388 2899 Fax (08) 9381 1708

www.mossensongalleries.com.au Email: art@mossensongalleries.com.au

Gallery hours: Mon-Fri 10am-5pm

Sat 11am-4pm

Member of ACGA

25 October - 20 November

Utopia Sculpture

Experimenting and drawing inspiration from their surrounds, the Kunoth family of Utopia use wild colours and unexpected forms, carving a menagerie of birds, animals and traditional figures with a flair and dynamism that is underpinned by an assured and perceptive vision. Their quirky figuration incorporates the everyday objects of postcolonial reality into an image world that also includes ceremony and custodianship of country, underlining the extraordinary ability of Indigenous myth to incorporate the settler world into a highly mutable and adaptive cosmology.

Artists of Bindi

Residing in Alice Springs these Mwerre Anthurre Artists only occasionally get to visit their country, as a result they paint their country from memory. Remembering and painting country is a celebration of connection to place with each new painting reinvigorating their culture, contrasted against a sadness at their separation from such a significant space. These paintings are imbued with such a sense of place the laws of time and space become circular as we the viewer are transported to this 'country'.



22 November - 18 December

Stories from the Kimberley

Showcasing a selection of artists who paint with an uninhibited outpouring of inspiration and joy that is reflected through their deep engagement and affection for their culture. Each map the significant features and Dreamtime stories of the Kimberley country in a unique and fascinating manner.

Mossenson Galleries will be open throughout the holiday period. Closed public holidays.



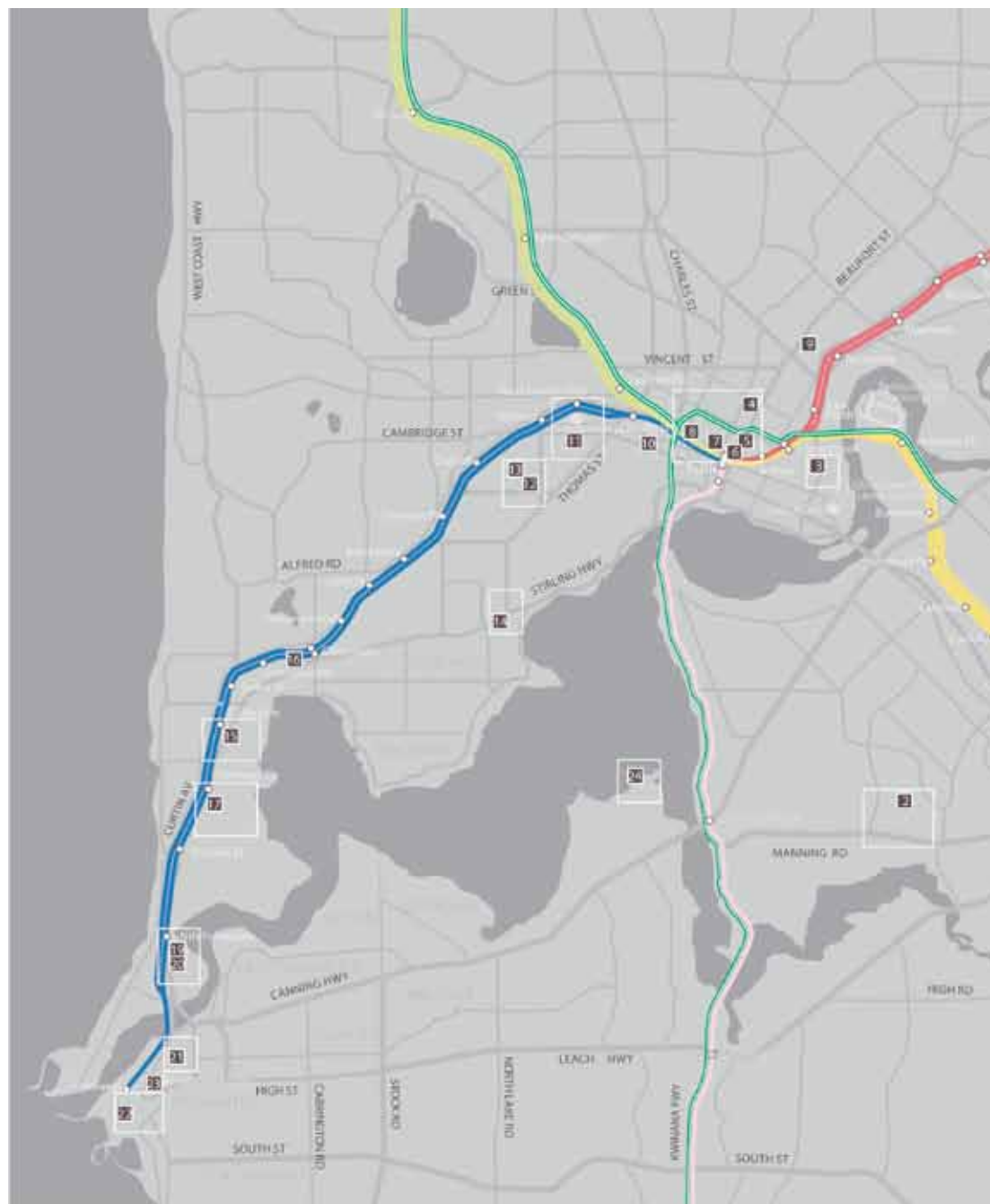

- 1 Gomboc Gallery Sculpture Pk, James Rd, Middle Swan
- 2 John Curtin Gallery, Curtin University of Technology, Kent St, Bentley
- 3 Holmes a Court Gallery, 11 Brown St, East Perth
- 4 Spectrum Project Space, 221 Beaufort St, Northbridge
- 5 Central TAFE Art Gallery, 12 Aberdeen St, Northbridge
- 6 Perth Institute of Contemporary Arts, Perth Cultural Centre, Northbridge
- 7 Art Gallery of Western Australia, Perth Cultural Centre, Northbridge
- 8 Breadbox Gallery, 233 James St, Northbridge
- 9 Emerge ART SPACE, 676A Beaufort St, Mount Lawley

- 10 Kingfisher Gallery, 49 Colin Street, West Perth
- 11 Indigenart, 115 Hay St, Subiaco
- 12 Lister Gallery, 316 Rokeby Rd, Subiaco
- 13 Seva Frangos Art, 71 Rokeby Road, Subiaco
- 14 Lawrence Wilson Art Gallery, University of WA, 35 Stirling Hwy, Crawley
- 15 Stafford Studios, 102 Forrest St, Cottesloe
- 16 Greenhill Gallery, 6 Gugerri St Claremont
- 17 Galerie Düsseldorf, 9 Glyde St, Mosman Park
- 18 Johnston Gallery, To Be Advised, please check gallery page

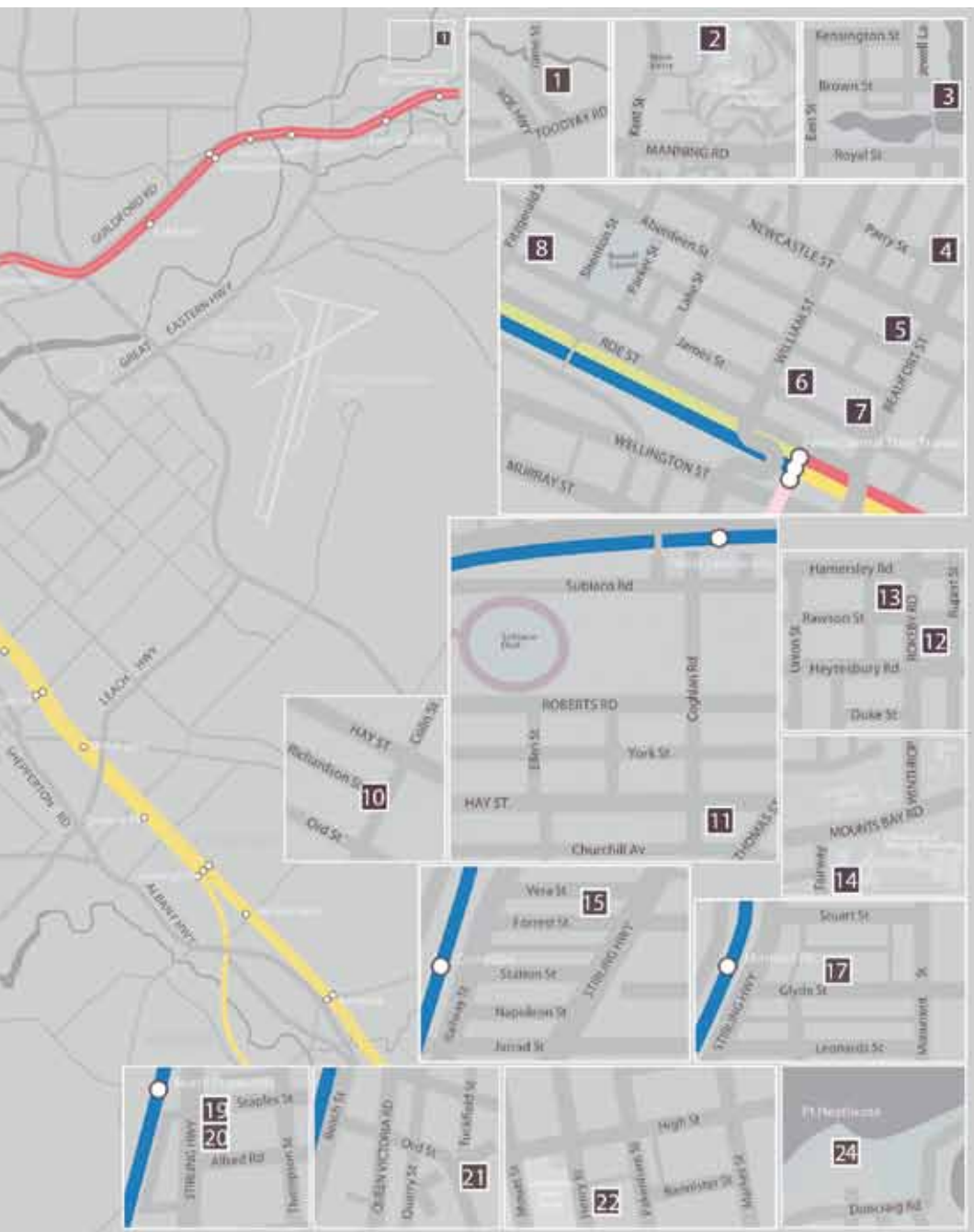

- 10 Gallery East, 94 Stirling Hwy, Nth Fremantle
- 20 Perth Galleries, 92 Stirling Hwy, Nth Fremantle
- 31 Fremantle Arts Centre, 1 Finnerty St, Fremantle
- 25 The Moores Building Contemporary Art Gallery, 46 Henry St, Fremantle
- 23 The Prison Gallery, Fremantle Prison, The Terrace Fremantle
- 24 Heathcote Gallery Dun Craig Road Applecross

- FREEWAY
- FREMANTLE LINE
- MIDLAND LINE
- ARMADALE LINE
- JOONDALUP LINE
- MANDURAH LINE

John Curtin Gallery

Curtin University, Kent Street, Bentley, WA, 6102
 Tel (08) 9266 4155 Fax (08) 9266 3878
www.johncurtingallery.curtin.edu.au Email: galler@curtin.edu.au
 Now on facebook

Gallery hours Mon - Fri 12 - 5 pm
 Sunday 31 Oct and 28 Nov 1 - 4 pm
 closed Saturdays and public holidays
 Free admission

17 Sep - 15 Oct

Postcards from Australia: Mapping Climates of Change **Rosalind Bonser, Nancy Lanario, Vicky Small and Virginia Walsh**

A group of distance art students from Curtin University, separated by some 4000km across three Australian states, have collaborated online to present their first exhibition at the John Curtin Gallery. The artists, Nancy Lanario and Vicky Small from WA, Virginia Walsh from the ACT and Rosalind Bonser from NSW explored the unique aspects of their local environments in their artwork, resulting in the creation of four large scale textile-based wall hangings, and smaller vessels made from fibres, free-machine embroidery and ceramics.



details from *Postcards from Australia: Mapping Climates of Change*, 2010

17 Sep - 10 Dec

Diseased Estate by Thea Costantino (drawing/installation) **Alternative Instructions for Every Day Life by Tanya Lee (video installations)** **Gather round me and I'll draw you a story by Lee Mansbridge (painting)** **Casino Sisyphus by Anna Nazzari (kinetic sculpture)** **Unlacing Carnal Margins by Angela Stewart (painting)**

In partnership with the Curtin University's School of Design and Art, the John Curtin Gallery presents solo exhibitions by five of the most exciting up and coming female artists practicing in Perth today. Historical imagery, modes of record and distortions of truth and ritual are explored in exhibitions of an international standard by respected artists, some of whom have already made an impact on the Perth art scene.

21 Oct - 19 Nov

twenty people twenty paintings

David Attwood

Thea Costantino *Symptom (b)* 2010
graphite on paper, 41 x 45 cm.



Angela Stewart *Poesis* 2007
acrylic, oil on wood, 129 x 90cm



Kingfisher Gallery

49 Colin Street West Perth 6005 (cnr Colin & Richardson Street)
Tel (08) 9486 9822 Fax (08) 9330 8004
www.kingfishergallery.com.au. Email: jan@kingfishergallery.com.au

Gallery hours Wed to Fri 11am - 4 pm
Sun 1- 4pm, or by appointment
closed public holidays

15 Sep- 10 Oct

Julie Podstolski *Geisha: The Allure of Mystique*

'Once or twice per year I travel to Kyoto to capture new photographs of geiko (the Kyoto term for geisha) and maiko (apprentice geiko) for my drawings. This is an exhausting task requiring patience and stamina. I pace the streets from morning until night with my heavy camera hoping to be in the right place at the right time. Long periods of no sightings can be 'spirit-crushing' however when these women come into view my exhaustion evaporates. Photography is the first stage in my process. It is risky. If my subjects are greeting one another or standing around chatting as they sometimes are, I have the luxury of time for composition. More often than not they are hurrying from one engagement to another so I click away in the seconds which I have. I enjoy that element of chance. It comes with an adrenaline rush.

Geiko and maiko are a feast for the eye; splendid living works of art. Their kimono are exquisite. Where else would an artist find such sumptuous eye-popping colours and designs worn with elegance and finesse? They bring to my mind "La Belle Epoque" (the Beautiful Era) of late 19th and early 20th century romantic fashion.

They embody the element of mystery. To an outsider artist maiko and geiko are unapproachable. They remain gorgeous, remote and ephemeral; contained in a separate dimension from ordinary life.'



Julie Podstolski *Kyoto a la Mode*

13 Oct- 7 Nov
Botanical Artists Group of WA

A Spring collection of botanical art by Pat Dundas , Ellen Hickman , Penny Leech, Philippa Nikulinsky , Margaret Pieroni and Katrina Syme. A collection of new works in watercolour by this renowned group of botanical artists

10 Nov - 12 Dec
Kimberley Kohan

Kohan, a well recognised painter of the Kimberley region and resident for 11 years, successfully captures the essence and the elements that contribute to the uniqueness of the Kimberley region in her paintings. Her style provides the viewer with a strong impression of the heat, the vast landscape and the occasional oasis for man, stock and wildlife. Kimberley Kohan has had many commissions and awards, the most recent award being first place in the Kimberley Environmental Exhibition, April 2010.



Kimberley Kohan *Kimberley Thirst*



Philippa Nikulinsky *Jewel Beetles, Taxandria*

Lawrence Wilson Art Gallery

The University of Western Australia 35 Stirling Hwy Crawley WA 6009
 Tel (08) 6488 3707 Fax (08) 6488 1017
 Email: info@lwgallery.uwa.edu.au
www.lwgallery.uwa.edu.au

Gallery hours Tue - Fri 11 am - 5 pm
 Sun 12 pm - 5 pm
 Free admission
 Contact the gallery or check the website for details of free talks

Until 31 Oct

Out of the Darkness: Prints and Drawings from The University of Western Australia Art Collection

For a variety of reasons many of the works within Lawrence Wilson Art Gallery's next exhibition, Out of the Darkness: Prints and Drawings from The University of Western Australia Art Collection, have not seen the light of day for many years. Following some intensive restoration the Gallery can now present this range of Australian and international prints and drawings from the late nineteenth century to the late twentieth century, many of which focus on key Modernist movements and styles ranging from Cubism, Surrealism, Social Realism and Geometric Abstraction.

There are many familiar names in the show, although the works themselves are less well known. Among the Australian artists represented are:

Charles Condor, George Lambert, Thea Proctor, Margaret Preston, Dorrit Black, Russell Drysdale and John Brack. International artists include Marc Chagall, Henri Toulouse-Lautrec, Reginald Marsh and Rockwell Kent.

14 Nov -19 Dec

and 18 Jan-27 Feb 2011

Tom Collins, and after: a bequest and its legacy

When it purchased a dozen paintings by Sidney Nolan in 1953, The University of Western Australia was making a bold and controversial move. The acquisition was made possible by the Tom Collins Bequest, which supported the development of a unique collection of Australian contemporary art. Over the next two decades works by twenty-five artists were acquired-many for the first time by any public collection in Western Australia and some, as with Nolan, in greater depth than anywhere else in the country.

This exhibition of Tom Collins' works, and others by the same group of artists, demonstrates the important legacy it has left. Together they are a great record of the period, and of a bold and perceptive engagement with the contemporary art of the time.



Guy Grey-Smith, Rottnest, 1954-57, oil on canvas, 61.2x76.5 cm (h,w), The University of Western Australia Art Collection, Tom Collins Bequest Fund, 1957, © The University of Western Australia

Lister Gallery

316 Rokeby Road Subiaco WA 6008

Tel (08) 9382 8188 Fax (08) 9382 8199

Email: admin@listergallery.com.au www.listergallery.com.au

Gallery hours Mon - Fri 10 am - 5 pm

Sat 2 - 4 pm, Sunday by appointment

Lister Gallery exhibits and deals in leading modern and contemporary art by prominent Australian artists.

The gallery represents artists including Marcus Beilby, Andrew Browne, Peter D Cole, John Firth-Smith, Amanda Marburg, Brent Harris, Dale Hickey, Robert Hunter, Robert Jacks, Tim Johnson, Tim McMonagle, Gregory Pryor & David Wadeldon.

A selection of important Australian art from the 50's to the present day is held in the stockroom and is available for viewing on request.

Offering a high degree of confidentiality and an unconditional guarantee of authenticity, Lister Gallery also provides expert advice on the formation, management, and conservation of private and corporate collections. The Gallery can provide valuations for donations, market appraisals and insurance and is an authorised valuer for the Commonwealth Government's cultural gifts program



Prison Gallery, Fremantle Prison

Fremantle Prison, The Terrace, Fremantle,
Tel. 9336 9200

Email: curatorial@fremantleprison.com.au www.fremantleprison.com.au

Gallery hours 9 am - 5 pm daily

Admission FREE to gallery

Until 21 Nov

Prisoners of Age - Ron Levine

This is what a life sentence looks like - Fremantle Prison has secured the exclusive Australian rights to a compelling photographic exhibition of inmates and staff in American and Canadian prisons. The confronting larger than life sized portraits are by internationally renowned Canadian photographer Ron Levine. His images incorporate the inmates' own words, revealing the stories of some of society's most marginalised members. The exhibition lends insight into why people commit crimes and brings important social issues surrounding the aging prison population to light.

This extraordinary project has been exhibited at Alcatraz Penitentiary, The National Archives of Canada, Eastern State Penitentiary, Philadelphia and Kilmainham Gaol, Ireland. There is an accompanying documentary on show and a hardcover publication.

Prisoners of Age at Fremantle Prison, 2010 © Ron Levine



27 Nov- 30 Jan

Insider Art: Recent Work by WA Prisoners

Featuring artwork, craft and items produced by inmates and prison industries. Through these exhibitions the Prison provides incarcerated men and women with the opportunity to showcase their creativity and skills beyond prison walls. There is a strong representation of Aboriginal art. Presented with the Department of Corrective Services, these remarkable works are available for purchase.



WA Prisoner Art
Lalanggarra (Crocodile), 2010 acrylic on canvas



Partnership with Tourism Australia
Major Tourism Attraction (2006, 2008, 2009)
Heritage and Cultural Tourism 2008



Responsible Minister is proud of the historical
places that together form the Australian
Cultural Sites World Heritage property

The Moores Building Contemporary Art Gallery

46 Henry Street Fremantle WA 6160

Tel (08) 9335 3519 Fax (08) 9432 9547

www.moores.org.au. Email: richiek@fremantle.wa.gov.au

Managed by The Fremantle Arts Centre

Daily during exhibitions Mon-Sun 10 am - 5 pm

1 - 17 Oct

Mandorla Art Exhibition and Prize. Group Exhibition.

This prestigious religious art exhibition and prize returns to the Moores Building. Featuring artists from all over Australia competing for the famed prize but also producing an exhibition of diverse styles and meaning which goes towards further understanding of the contemporary nature of our lives and beliefs.

22 - 31 Oct

Cancer Council Invitational. Group Exhibition

An invitation exhibition of local artists organized by the Cancer Council of Western Australia. This is a further chance to see the best that is on offer from the local art scene.

5 - 21 Nov

Drawn Together - the art of Life in Fremantle. Ian de Sousa

This event will be an important and unique experience within the 2010 Fremantle Festival. Artists and performers will engage in a sublime event that captures the vitality of the moment, in a creative exchange, transforming action to representation. Celebrate the power of artistic relationships that draws upon the excitement and diversity of life within the city through this drawing extravaganza. Events with public participation will be happening in the Moores during the 10 days festival including life drawing each day upstairs and lectures scheduled through out. See the Fremantle Festival program for further information and times.

26 Nov - 5 Dec

Renaissance. Lindsay Pow.

This exhibition has been a decade in the making. It covers numerous images from life and landscape. Described by the artist as a change in direction this exhibition of paintings also signifies a personal renaissance.

10 - 19 Dec.

Paintings, Drawings, Prints, Installations. Group Exhibition

Featuring local contemporary artists Chris Bennett, Judy Bodger, Panisca D Carnaby, Cathy Charnaud, Elizabeth Carroll, Kate Fuderer, Garimo, Matt Garrity, Jenny Gorman, Andrew Home, Debra Love, Gail Mason, Yvonne Merchant, Andrew McQuoid, Renata Niderla, Helen Pereira, Suzie Paterson, David Ralph, Chris Scott, Margaret Sommerville & Pattie Vincent

23 Dec - 9 Jan

Freedom School. Group Exhibition.

An exhibition from the Freedom School of Painting a group artists practising and promoting an intuitive and open ended experimental approach to painting curated by artist and teacher David Giles.

Ian de Souza *Drawn Together*
(Festival of Fremantle artwork)
Ink on rice paper. 80 x 120 cm, 2010



Lindsay Pow *Belladong Country*
Oil on canvas, 150 x 140cm. 2010



Perth Galleries

92 Stirling Highway North Fremantle
Tel (08) 9433 4414 Fax (08) 9433 4415

www.perthgalleries.com.au Email: admin@perthgalleries.com.au

Representing Sotheby's in Western Australia

Gallery hours Tue - Fri 10 am - 5 pm

Sat 11 am - 5 pm, Sun 2 pm - 5 pm

Closed public holidays and long weekend

Member of Australian Commercial Galleries Association

24 Sep - 17 Oct

Annie Hsiao - Wen Wang

'Illume'

If Rothko polished the world to an icy emptiness, Annie Hsiao-Wen Wang tunes it to melodic perfection.

-David Bromfield.

Wang's colourist abstract paintings seek to fill the viewer's field of vision, providing an opportunity to meditate on the numinous and emotional. Referencing the techniques and fascinations of painters ranging from Rembrandt to Rothko and Turner, Annie Hsiao-Wen Wang provides viewsapes for a reflective state of human consciousness. Grand and cinematic, this body of work of extraordinary luminosity is achieved through slow glazing, providing a complex play of colour, light and shadow.

Annie Hsiao *Nightingale* 2010 Oil on Canvas 137 x 137 cm

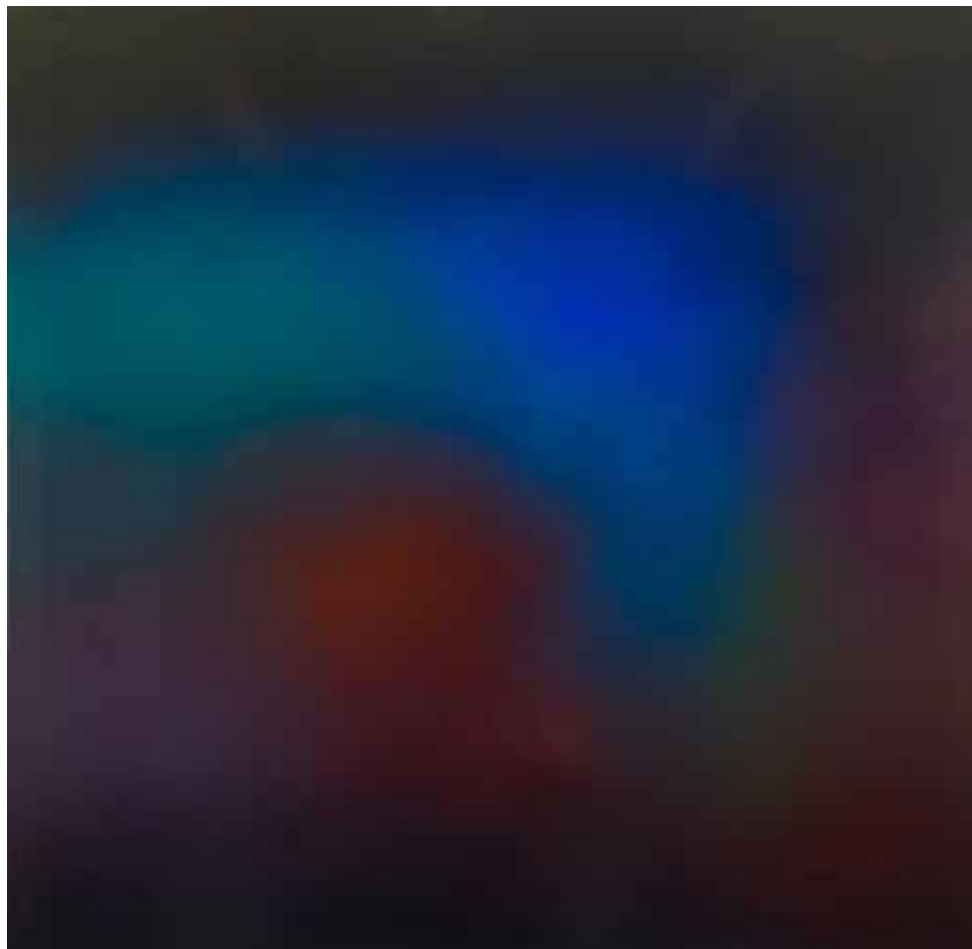

Britt Salt '(_)' 2010, C-type print, 100x65cm



22 Oct - 14 Nov

Britt Salt

Ma: an interval in time and space*

Ma brings together a series of unhinged spatial objects and environments. The manifold nature of these works allow them to simultaneously tessellate, merge and divide as the viewer moves around them, posing the question, how do we orientate ourselves in a space which is unfixed and in a constant state of flux, or Ma?
*English translation from Japanese

19 Nov - 12 Dec

Four Painters - R J Dorizzi, Giles Hohnen, Chris Hopewell, Jeremy Kirwan-Ward

This exhibition brings together four friends working within the genre of non-representational painting. Their directions are diverse and distinctly different : R J Dorizzi reveals a refined and delicately coloured geometric sensibility, while Giles Hohnen revisits a looser, more painterly approach to abstraction. Chris Hopewell weaves collage into calligraphic, gestural mark-making and Jeremy Kirwan-Ward builds on a body of work that utilises translucent veils of free-flowing paint. These approaches make for a surprisingly cohesive and intriguing show

Perth Galleries will be closed from December 17 re opening on February 3

Perth Institute of Contemporary Arts

Perth Cultural Centre James Street Northbridge WA 6001
Tel (08) 9228 6300 Fax (08) 9227 6539
www.pica.org.au Email: info@pica.org.au

Gallery hours Tue - Sun 11 am - 6 pm

Free admission to all exhibitions

11 Sep- 24 Oct

Objects to Live By: The Art of John Meade

Curated by Zara Stanhope

Objects to Live By: The Art of John Meade focuses on the practice of one of Australia's most significant contemporary sculptors. His carefully constructed and often witty sculptural forms begin with a chance encounter with found objects. Curated by Zara Stanhope, this exhibition is a dynamic survey of fifteen years of John Meade's complex practice and documents the evolution of his ideas and working methods through an insightful selection of works dramatically ranging in scale and media.

11 Sept - 14 Nov

Love of Diagrams

Curated by Leigh Robb

Armando Andrade Tudela (Peru), Bradford Bailey (USA/UK), Jose Damasceno (Brazil)
Natasha Dusenjko (Vic), Marita Fraser (Australia/Austria), Joyce Hinterding (NSW),
Bojan Sarcevic (Bosnia/France), David Thomson (WA)

Diagrams, patterns, series and systems - these modernist and conceptual strategies are being negotiated anew by many artists today. Love of Diagrams brings together key works by leading and emerging international and Australian artists who are creating their own idiosyncratic logic for investigating everything from politics and social patterns to time, energy and architecture. Embracing drawing, collage, painting, sound and installation, this exhibition questions the origins of these artists' obsessions with all things diagrammatic and what this signals as a means of representing, mapping and articulating current ideas.

Sekilala

SHIMURABROS. (JAPAN)

Yuka and Kentaro Shimura are SHIMURABROS., a sister and brother duo based in Yokohama, Japan. They are interested in the history of the motion picture from the Lumiere Brothers to Buster Keaton and its evolution into the twenty-first century. They are driven by a desire to extend film beyond its two-dimensional limitations by employing increasingly advanced 3D technology and virtual reality programming.

6 Nov - 19 Dec

Opening: Friday 5 November

Complete Burning Away

Natascha Stellmach

In 2008, Galerie WAGNER + PARTNER in Berlin exhibited Natascha Stellmach's project, Set me free, a complex exploration of the myth of immortality, based around a Joint containing the alleged ashes of Kurt Cobain. This exhibition will show the full development of this long-running and controversial project where Stellmach has created new videos, text and installation works that interrogate and reflect upon the intense public and mass media response in response to the smoking of the ashes of Nirvana's infamous lead singer.

Armando Andrade Tudela
Triangulos #1 2008
Courtesy of the artist and
Carl Freedman Gallery, London



Natascha Stellmach
Commodity 2009 (detail)
Courtesy of the artist



Seva Frangos Art

Indigenous and Contemporary

271 Rokeby Road Subiaco 6008

Tel (08) 9380 9938 Fax (08) 93809939 Mob 0407 992 309

www.sevafrangosart.com Email: seva@sevafrangosart.com

Gallery hours Tues - Sat 11am - 5 pm

Appointments welcome

With over thirty years experience in public art museums and federal government agencies, Seva Frangos Art is based on excellence and best practice. The primary focus of the gallery is showcasing Australia's finest indigenous artists and the gallery specializes in artworks produced in natural ochre and pigments, in particular those sourced from the East Kimberley, Western Australia and from across the 'top end' of the Northern Territory including Arnhem Land and the Tiwi Islands.

Oct

Mabel Juli Karnkiny + Marlene Juli Gurlabal

The sensual surfaces of earth ochres and pigments and the supremely elegant compositions are truly memorizing. Mabel Juli is a master of paintings that are deceptively minimal yet are deeply embedded in Gija culture.

I started painting when the old girl (Queenie McKenzie) was here...I was doing the Karnkiny (Moon Dreaming). That's the painting I started with because my mother and father told me that Ngarrangkarni story.

This is Yarity country in Darrajayin, Springvale Station, and is Mabel Juli's traditional country. The landforms are all part of the Ngarrangkarni Dreaming. Karnkiny Ngarrangkarni is a love story about a man who is heartbroken as he cannot marry the beautiful girl with long black hair who he loves and rather than stay on earth without her he is forever in the night sky, coming back to life every month as the moon. Mabel Juli, a finalist in this year's Telstra Art Awards, is one of the best known artists at the Warmun Art Centre, East Kimberley. This exhibition is a superb collection of paintings by Mabel Juli and these are complimented with a suite of paintings, Gurlabal, by Marlene Juli.

Marlene Juli has already established a reputation for her distinct, fluid and strong paintings and is one of the most original younger artists from the region. This exhibition showcases for the first time major paintings by mother and daughter.

Opening 11 Dec

Big Presence - Small Presents

Annual festive season exhibition of 100 paintings - 25 x 25 cm - by 5 leading artists from Waringarri Aboriginal Arts and 3 new artists from Kalumburu; Each painting is \$271.

Marlene Juli

Gurbaba/ 2010

Natural ochre on canvas 50 x 150 cm



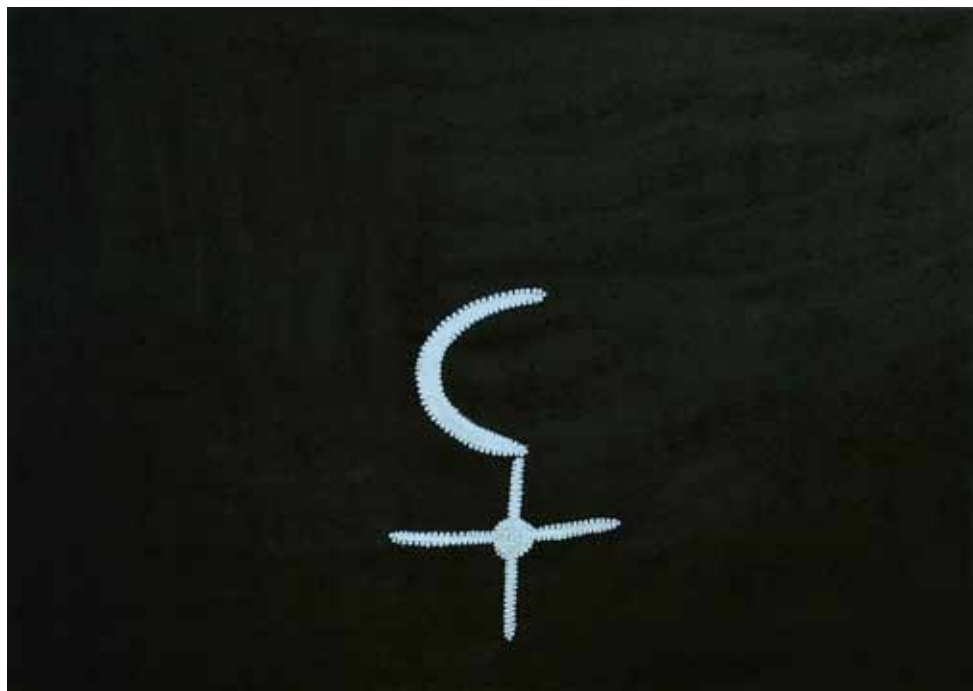

Mabel Juli *Garkiny Ngarrangkarni* 2010
Natural ochre and pigment on canvas
100 x 140 cm

Stafford Studios

102 Forrest Street Cottesloe WA 6011

Tel (08) 9385 1399 Fax (08) 9384 0966

www.staffordstudios.com.au Email: artstaff@iinet.net.au

Gallery hours Tue-Fri 10 am - 5 pm

Sun 2 pm - 5 pm

6- 24 Oct

Mixed Show

In celebration of this occasion the exhibition will feature new works from our currently represented artists.

28 Oct - 21 Nov

William Boissevain Retrospective exhibition

To celebrate the long & distinguished career of William Boissevain Obe, Stafford Studios will present a retrospective of his life & paintings & also some beautiful new works.

25 Nov - 19 Dec

Michael Challen

We are proud to present new works by acclaimed realist painter Michael Challen. Michael has the ability to paint the Australian landscape with a realistic style but each of his paintings has a soul to it .

Ivars Jansons *Venetian Afternoon* 60 x 83 cm oil on canvas



William Boissevain *Waiting for the Dance*
53 x 73 cm oil on board



Michael Challen *Blue Horizon, Lennard River*
103 x 76 cm oil on linen



spectrum project space

221 Beaufort Street, Northbridge WA 6003

Tel (08) 9328 2088

www.scca.ecu.edu.au/projects/spectrum Email: spectrum@ecu.edu.au

Gallery hours Wed - Sun 2 pm-6 pm

Free Admission

Spectrum Project Space

spectrum@ecu.edu.au / www.sca.ecu.edu.au/projects/spectrum

Since its inception in 2001, Spectrum Project Space has become one of Perth's most important venues for emerging artists and has been a valuable contributor to the growth of the WA arts sector.

However in mid February Spectrum Project Space closed doors on the premises at 221 Beaufort Street in Northbridge.

ECU is currently working to establish a dynamic new space and is planning creating a fantastic multi disciplinary program for 2011.

We will be keeping you up to date on Spectrum developments, as well as exhibitions involving the ECU community via our newsletter, so if you are not already a subscriber, you can become one by visiting <http://www.sca.ecu.edu.au/projects/spectrum/newsletter.html>

In the meantime if you have any questions or comments, please email spectrum@ecu.edu.au

Annie Hsiao-Wen Wang *Prayer* 2009 (detail view) Life-size concrete cast



ImageLab

Digital services

Specialising in:

Photographic reproduction and documentation

Exhibition and gallery prints

Large format printing (eg. 1.6 x 3 m Wide)

Fine Art prints on archival materials

Colour managed quality drum scans

Water colour papers, canvas and fabric

Colour correct Art reproduction

using state of the art reproduction techniques

Managed by Tony Nathan

by appointment

0410 441 451 37 Vine St North Perth

tony@imagelabstudio.com

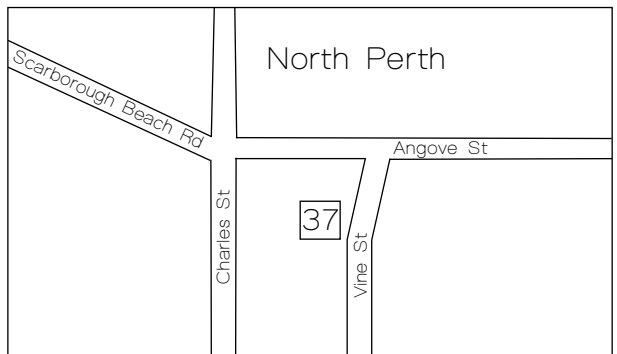



ART PRESENTATIONS

Distinctive Framing & Presentation Techniques

Working with WA Living Artists since 1982

30 Graylands Road
Claremont Perth
Western Australia 6010

(08) 9385 1200 Ph
(08) 9384 2164 Fax

Gallery CIRCUIT SUBSCRIPTION

one year (four issues) for \$16.50*

Please complete this form below or a photocopy, make your cheque or money order payable to
'The Association of Western Australian Art Galleries Inc' and post to:

Gallery Circuit Subscription

C/- Gallery East

94 Stirling Highway

North Fremantle, WA 6159

name _____

address _____

_____ post code _____

e-mail address _____

telephone _____ date _____

Please note: The red dot indicates that renewal of your annual subscription is due.

*includes \$1.50 GST



Max Ernst *Attirement of the bride* 1940 oil on canvas

Peggy Guggenheim Collection, Venice © Max Ernst/ADAGP. Licensed by Viscopy, 2010
At The Art Gallery of Western Australia